

CORREDERAS



CORREDERA PARA COCINA H150mm

Guía de Instalación

Formato sin escala

14E

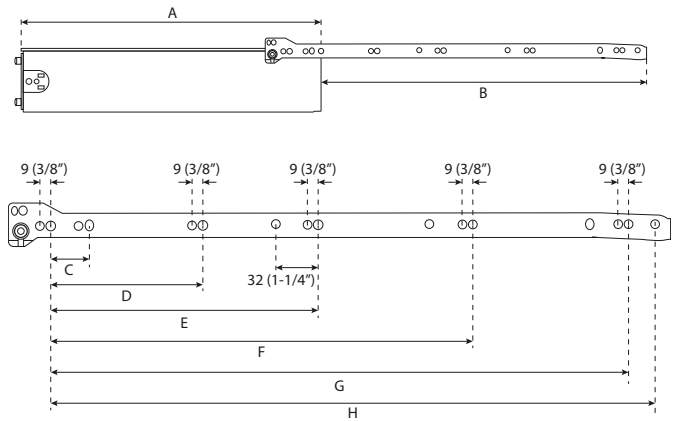

CODE/ CÓDIGO	COLOR	A	B	C	D	E	F	G	H	
14E180A	White /Blanco	17-11/16" / 450mm	14-1/8" / 358mm	1-1/4" / 32mm	5-1/16" / 128mm	8-13/16" / 224mm	13-7/8" / 352mm	-	-	10
14E200A	White /Blanco	19-11/16" / 500mm	15-11/16" / 399mm	1-1/4" / 32mm	5-1/16" / 128mm	8-13/16" / 224mm	13-7/8" / 352mm	17-5/8" / 448mm	-	10
14E220A	White /Blanco	21-5/8" / 550mm	17-7/16" / 443mm	1-1/4" / 32mm	5-1/16" / 128mm	8-13/16" / 224mm	13-7/8" / 352mm	17-5/8" / 448mm	18-7/8" / 480mm	10
14E180C	Gray /Gris	17-11/16" / 450mm	14-1/8" / 358mm	1-1/4" / 32mm	5-1/16" / 128mm	8-13/16" / 224mm	13-7/8" / 352mm	-	-	10
14E200C	Gray /Gris	19-11/16" / 500mm	15-11/16" / 399mm	1-1/4" / 32mm	5-1/16" / 128mm	8-13/16" / 224mm	13-7/8" / 352mm	17-5/8" / 448mm	-	10
14E220C	Gray /Gris	21-5/8" / 550mm	17-7/16" / 443mm	1-1/4" / 32mm	5-1/16" / 128mm	8-13/16" / 224mm	13-7/8" / 352mm	17-5/8" / 448mm	18-7/8" / 480mm	10

Space requirement

NL= Nominal Length

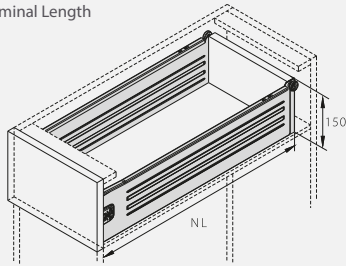
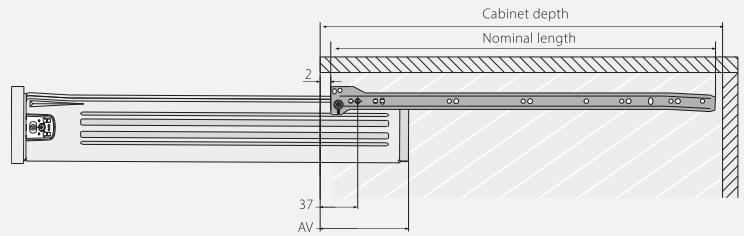

Illustration of the extension loss (Av)

Cabinet depth (Cmin) = Nominal length+3



Slide mounting illustration (mm)

Bottom panel width = Cabinet width-31

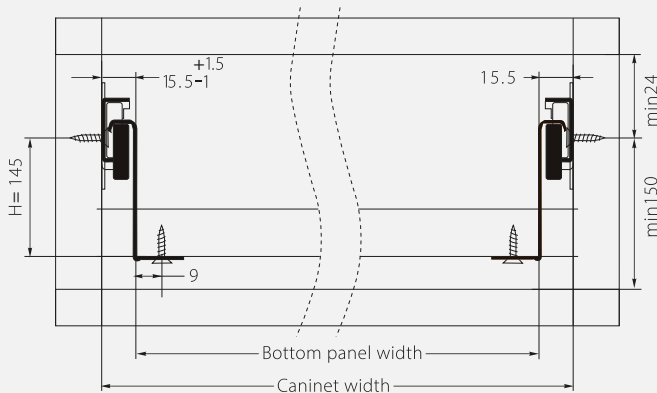

Front connector

Back

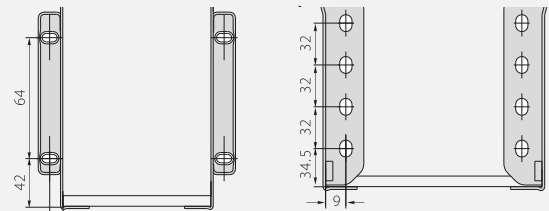

Adjustment

